

PRESTIGE INDUSTRIAL PIPEWORK EQUIPMENT LTD.

**LIGHTWEIGHT
SPLIT-FRAME
PIPE CUTTING MACHINES**



MCA CUTTER Range Ø 23-762 mm (1"-30")

Cold Cutting Pipe Cutting / Beveling Machine

Range: 1" - 30" o/d (larger available on request)

Functions: cutting, bevelling, facing, counterboring.

Materials: any kind of steel

Power: pneumatic, electric, or hydraulic

Note: the MCA Cutter range of portable pipe cutting and bevelling machines are designed for easy use even in difficult situations. Thanks to its split frame, low profile and lightweight it can be handled by one operator most of the time.



Pipe cutter MCA in pneumatic version, easy to set up thanks to lightweight and low clearance.



Developed for on site use in pipelines, machine body is split frame type allowing set up of machine at any point along pipelines.



Hydraulic Motor available for some sizes

TECHNICAL FEATURES

		MCA1	MCA2	MCA3	MCA6	MCA10	MCA14	MCA18	MCA24	MCA30
Pneumatic motor power	Hp (W)	0,7 (510)	1,33 (750)	1,81 (980)	1,81 (980)	3,0 (2200)	3,0 (2200)	3,0 (2200)	3,0 (2200)	3,0 (2200)
Air working pressure	psi	90	90	90	90	90	90	90	90	90
Electric motor power	Watt	750	1020	1020	1020	-	-	-	-	-
Voltage	Volt	220	220	220	220	-	-	-	-	-
Frequency (cycles)	Hertz	50	50	50	50	-	-	-	-	-
Hydraulic motor power	Hp (W)	-	-	-	-	8,4 (6,2)	8,4 (6,2)	8,4 (6,2)	8,4 (6,2)	8,4 (6,2)
Oil working pressure	bar	-	-	-	-	1500-1700	1500-1700	1500-1700	1500-1700	1500-1700
Toolbox stroke	inches	30,0	40,0	50,0	60,0	60,0	60,0	60,0	60,0	60,0
Radial feed rate per rev.	inches	0,0040	0,0040	0,0040	0,0040	0,0040	0,0040	0,0040	0,0040	0,0040
Weight	Kg	18	22	26	44	57	69	85	100	94
Idle Speed	rpm	48	37	30	22	16	13	11	9	13

DIMENSIONS AND SIZES

MOD.	RANGE	SUPPLY	DIM. (mm) A	DIM. (mm) B	DIM. (mm) C	DIM. (mm) D	DIM. (mm) E	DIM. (mm) F	DIM. (mm) G
MCA1	1" - 3 1/2"	pneum. electric	380	145	152,5	264,5	114	228	112
			570	145	152,5	264,5	114	228	112
MCA2	2" - 6"	pneum. electric	450	159	195,5	342,5	145	290	174
			590	159	195,5	342,5	145	290	174
MCA3	3" - 8"	pneum. electric	490	159	229	396,5	172	344	227
			620	159	229	396,5	172	344	227
MCA6	6" - 12"	pneum. electric	490	159	283	511	226	452	335
			620	159	283	511	226	452	335
MCA10	10" - 16"	pneum. hyd.	520	159	345,5	615,5	268	536	419
			350	159	345,5	615,5	268	536	419
MCA14	14" - 20"	pneum. hyd.	520	159	396,5	717,5	319	638	521
			350	159	396,5	717,5	319	638	521
MCA18	18" - 24"	pneum. hyd.	520	159	455	830	373	746	625
			350	159	455	830	373	746	625
MCA24	24" - 30"	pneum. hyd.	520	159	530	980	448	896	775
			350	159	530	980	448	896	775
MCA30	30" - 36"	pneum. hyd.	520	159	651	1198	547	1094	940
			350	159	651	1198	547	1094	940

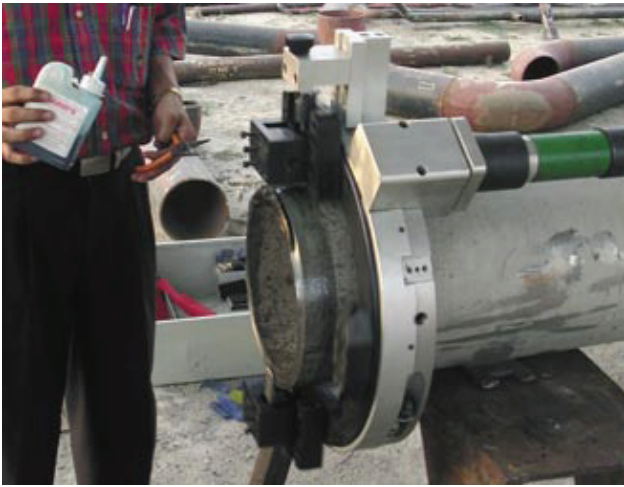

Aluminum body allows easy one man handling and set up.

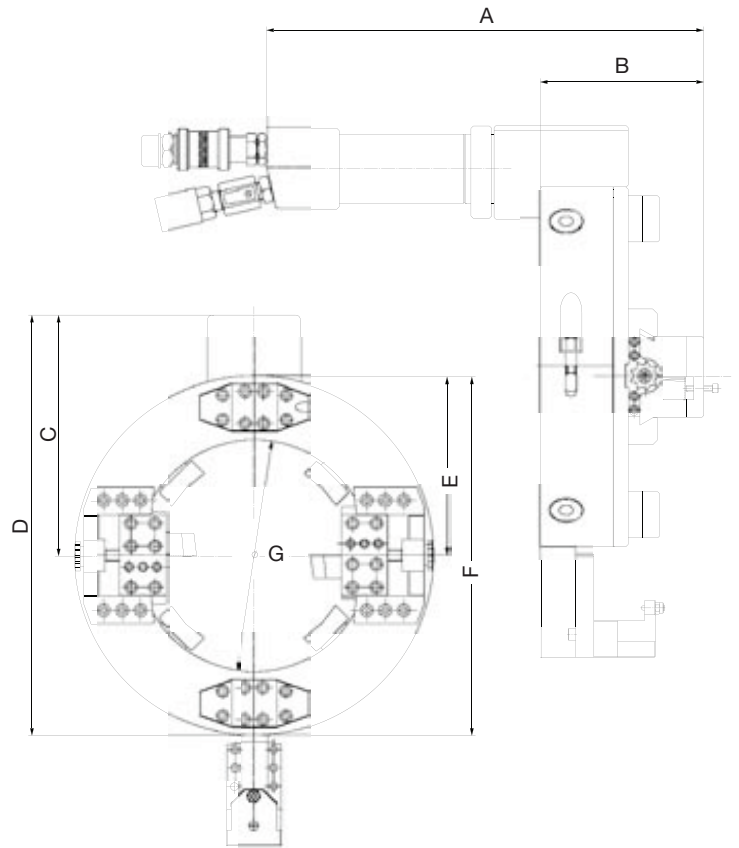

EXAMPLES OF CUTTER BITS

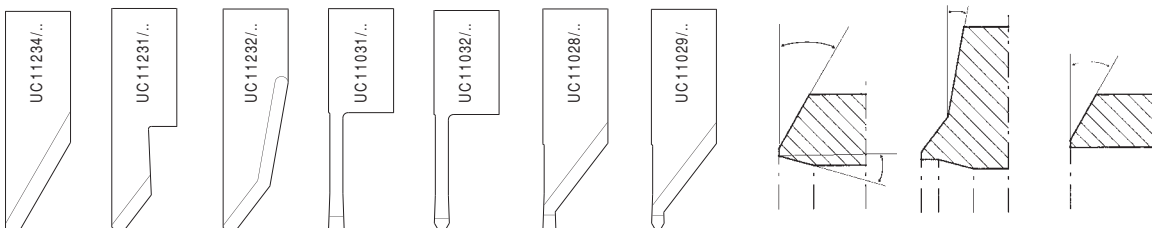

OPTIONALS



Motors available with 90° positioning for set up in restricted spots.

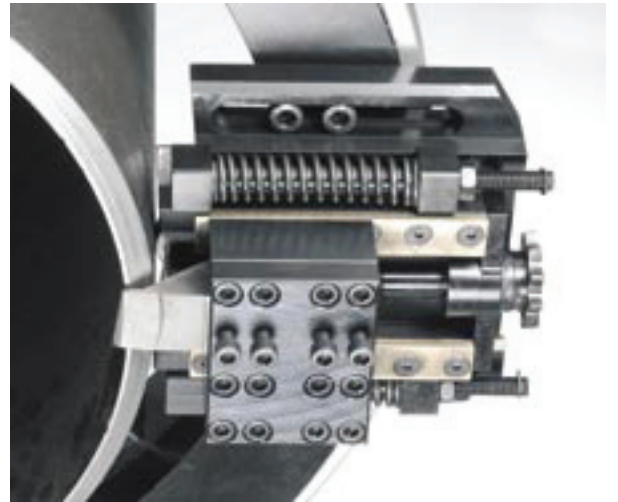

Available two copier toolboxes for following the pipe OD profile, then minimizing the bevel offset due to out of round of pipe.

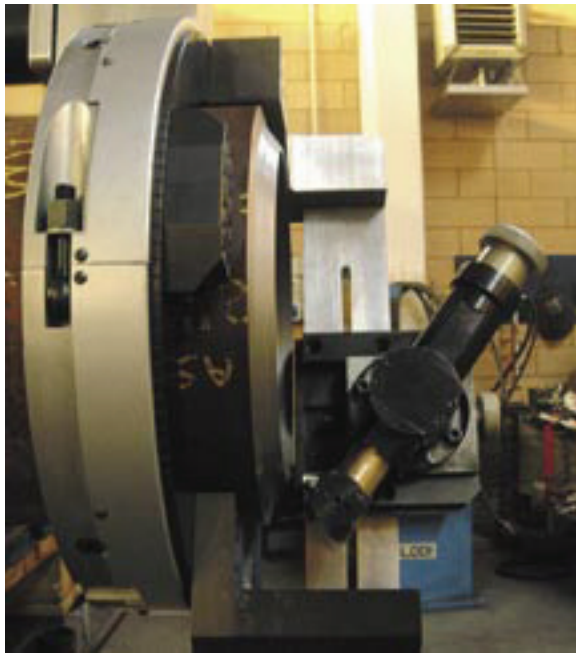

Crossbar allows rigidity and precision when making bevel on pipes with wall thickness over 50 mm (2"), also for inside bevel and ID boring up to 100 mm depth.



Hydraulic power pack oil tank 200L, with remote control and intercooler for non stop working session.

All units are supplied complete with service wrenches, drawings, instruction manual and warranty certificate.
Each unit is supplied with a protective box.

We strongly recommend the use of a portable filter lubricator with all our pneumatic models.

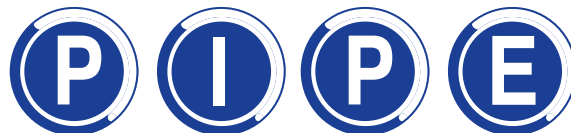

PRESTIGE INDUSTRIAL PIPEWORK EQUIPMENT LTD.

Unit L10, Telford Road, Bicester, Oxon. OX26 4LD
Tel: +44 (0)1869 324424 Fax: +44 (0)1869 323273
Website: www.pipe-ltd.com Email: sales@pipe-ltd.com

